

NOTE: THIS DRAWING IS PRELIMINARY. PLEASE REFER TO THE CERTIFIED BLUEPRINT FOR FINAL DIMENSIONS.

Horizontal Distance	Inside Clearance
1'	8'-5.5"
2'	9'-4.5"
3'	9'-10.5"
4'	10'-3"
5'	10'-7.5"

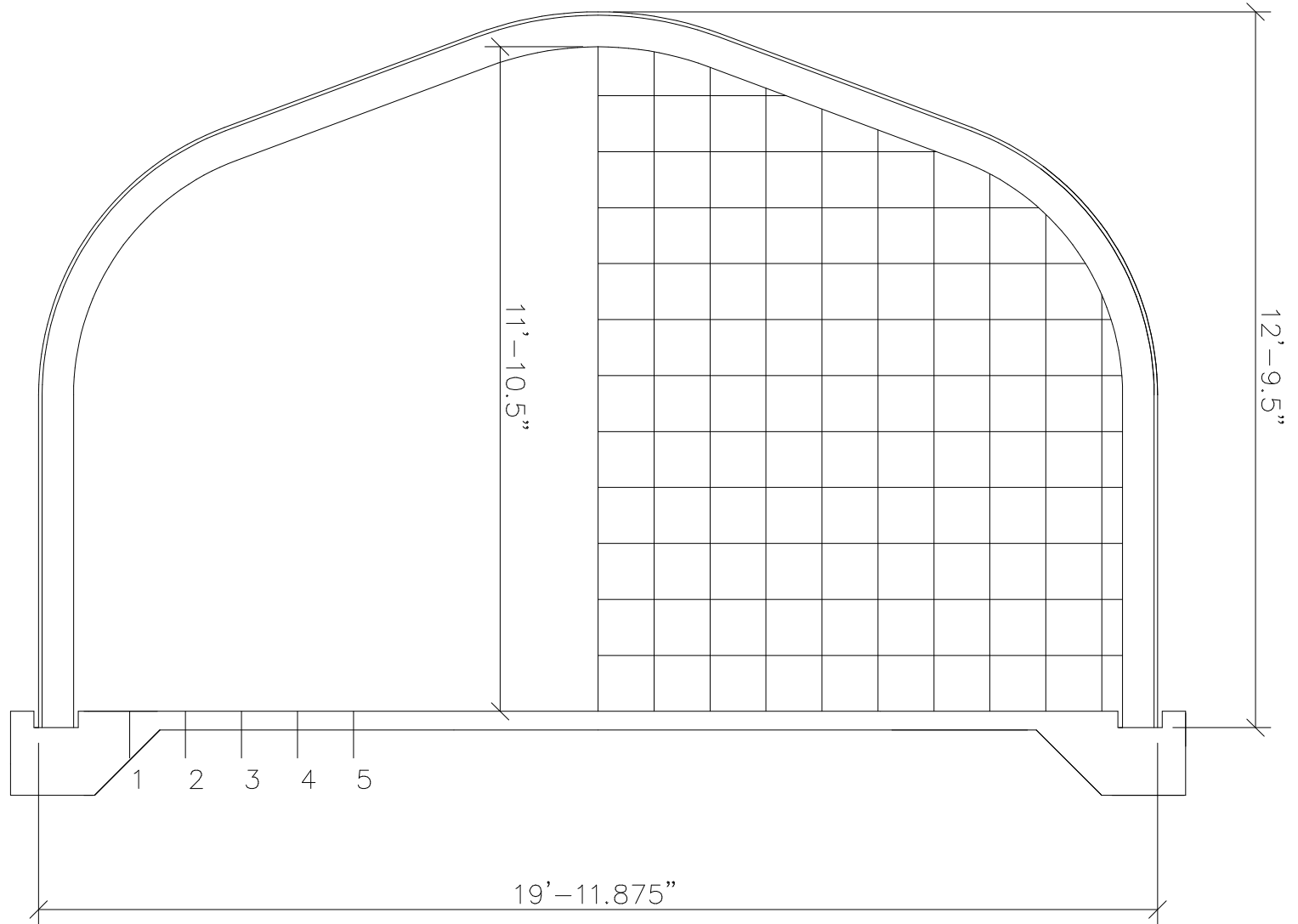

str. panels: 2@57.56	1 peak panel: 71.44	bolts/arch: 140	Date: 3/14/2017
2 eave panels: 92.25	str. wall panels: 2@71.44		
Endwall area, sq.ft: 254.47	Volume/ft, cu.ft: 249.34	Surface area/arch, sq.ft: 96.46	Total arch length: 459.94